

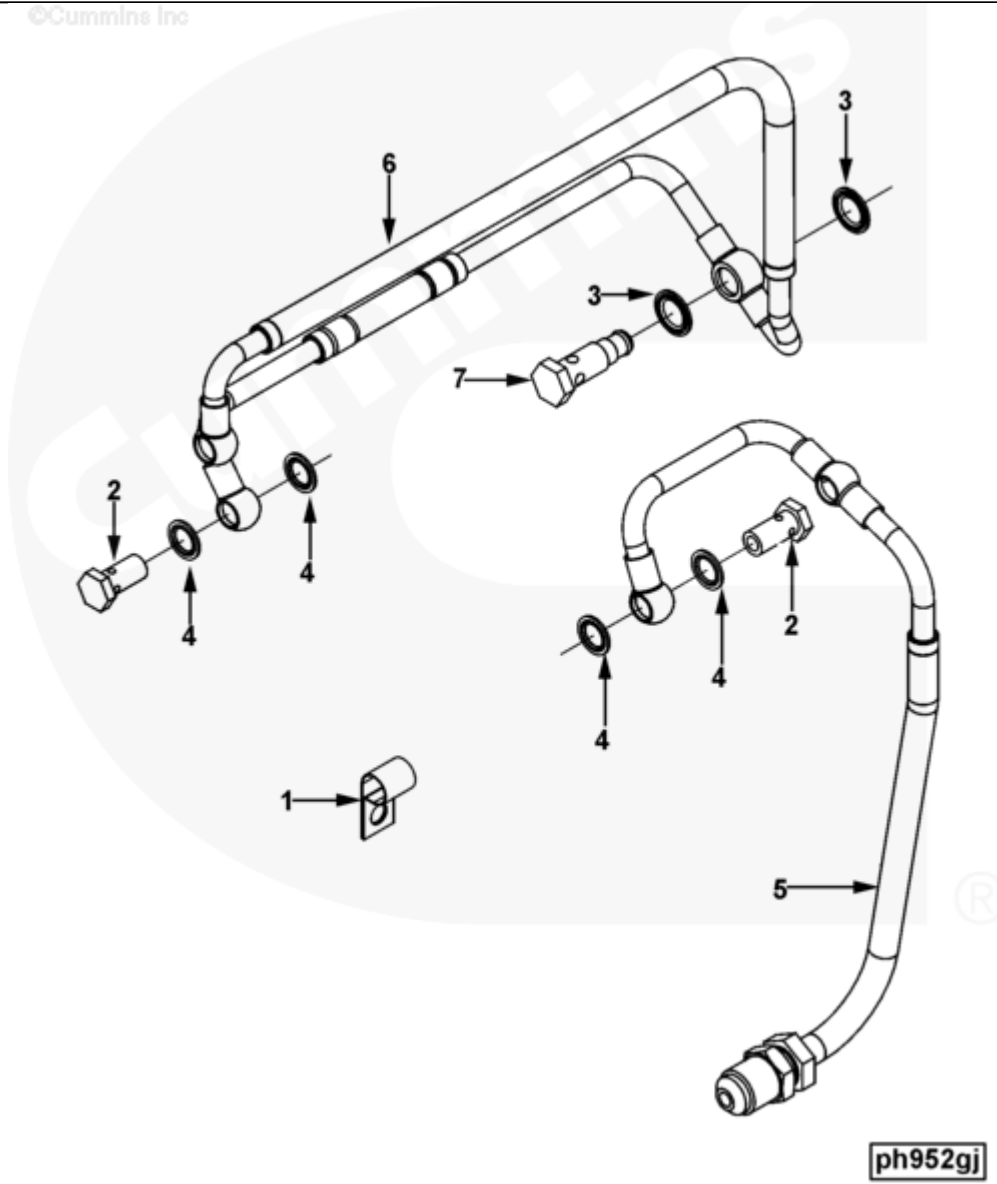

Parts Catalog - Option Detail

Electronic Parts Catalog - Option Detail				
Option	Group	Graphic	Film Card	Date
PH9065-06	06.03	ph952gj	Z	02-MAY-05
Engines	6C8.3, C GAS PLUS CM556, G8.3, G8.3 CM558, GTA8.3 CM558, ISC CM2150, ISC CM554, ISC CM850, ISC8.3 CM2250, ISC8.3 G CM2180 C101, ISL CM2150, ISL CM554, ISL CM850, ISL G CM2180, ISL8.9 CM2150 L110, ISL8.9 CM2880 L112, ISL9 CM2150 SN, ISL9 CM2250, ISL9 CM2350 L101, ISL9 CM2350 L111, ISLE4 CM850, L GAS PLUS CM556, L8.9, L8.9 L121, L8.9G CMOH2.0 L125B, L9 CM2350 L116B, L9 CM2350 L119B, L9 CM2350 L120C, L9 CM2350 L123B, L9.3 L105, L9.5 L117, L9N CM2380 L124B, QSC8.3 CM2250, QSC8.3 CM2880 C102, QSC8.3 CM554, QSC8.3 CM850(CM2850), QSL9 CM2250, QSL9 CM2250 L115, QSL9 CM2350 L102, QSL9 CM2350 L107, QSL9 CM2350 L118, QSL9 CM2350 L122, QSL9 CM554, QSL9 CM850(CM2850), QSL9 G CM558, QSL9 M CM2250 L106, QSL9.3 CM2880 L113			



ph952gj

Cart	Ref No	Part Number	Part Description	Required	Remarks
View My Cart					
		PH9065-06	Engine Control Module Plumbing		MR - PLUMBING, ENGINE CONTROL... (More)
					MODULE
					Engine Family: C & L Series
					Gear Pump Inlet Port
					Location:
					Centerline of Crank to
					Centerline of Inlet
					(mm): 206
					Centerline of Engine to
					Centerline of Inlet
					mm): 337
					Front Face of Block to Inlet
					(mm): -210
					ECM Outlet Port Location:
					Centerline of Crank to
					Centerline of Outlet
					(mm): 166
					Centerline of Engine to
					Centerline of Outlet
					(mm): 222
					Front Face of Block to Outlet
					(mm): -587
					ECM Inlet Port Location:
					Centerline of Crank to
					Centerline of Inlet
					(mm): 166
					Centerline of Engine to

					Centerline of Inlet
					(mm): 259
					Front Face of Block to
					Inlet (mm): -587
					Fuel Connection Outlet Port
					Location:
					Centerline of Crank to
					Centerline of Outlet
					(mm): 403
					Centerline of Engine to
					Centerline of Outlet
					(mm): 40
					Front Face of Block to
					Centerline of Outlet
					mm): -617.5
<input type="checkbox"/>	1	68425	Clip	2	
<input type="checkbox"/>	2	3903035	Banjo Connector Screw	4	M12 X 1.50 X 24.
<input type="checkbox"/>	3	3963988	Sealing Washer	2	M14.
<input type="checkbox"/>	4	3963990	Sealing Washer	8	M12.
<input type="checkbox"/>	5	3978477	Fuel Supply Tube	1	
<input type="checkbox"/>	6	3967151	Fuel Supply Tube	1	
<input type="checkbox"/>	7	3968686	Check Valve	1	